

ONE HOLE HYLUG™ CODE CONDUCTOR STANDARD BARREL (Continued)

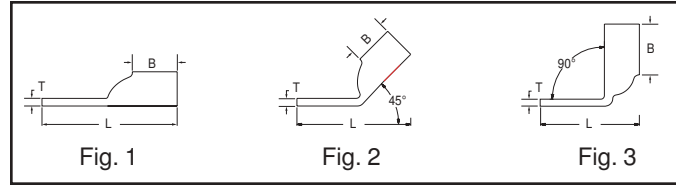
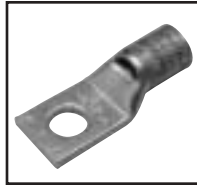

C-10

Catalog Number	Fig #	Conductor		Stud Hole Size	Tongue Width	Figure Dimensions			▲ Installation Tooling					Wire Strip Length											
		AWG	*** MM ²			(B)	(T)	(L)	Dieless (# of crimps)	Mechanical		Hydraulic			Color Code	Die Index									
										MD6, OUR840, MD7-34R	BCT500HS, Y500CTHS	Y35, Y39, Y750, Y46*, PAT750													
YA6CL4-BOX	1	#6 AWG		3/8"	.63"	.54"	.06"	1.28"	Y1MR (1)	W5CVT (1)	W5CVT (1)	U5CRT (1)	Blue	7	7/8"										
YA6CL4-45	2							1.17"		W5CRT (1)	W5CRT (1)														
YA6CL4-90	3							1.05"		X5CRT (1)	X5CRT (1)														
YA6CL6-BOX	1							1/2"		.75"	.54"					.12"	1.60"	MY29-3 (1)	X8CART (1)	X8CART (1)	UBCABT (1)				
YA6CL6-45	2																1.54"		X8CART (1)	X8CART (1)					
YA6CL6-90	3																1.30"		X8CART (1)	X8CART (1)					
YA5CL-BOX	1	#5 AWG		1/4"	.44"	.81"	.07"	1.65"	Y2MR (1)	W5CRT (1)	W5CRT (1)	U5CRT (1)	Blue	7	7/8"										
YA5CL-45	2							1.31"		W5CVT (1)	X5CRT (1)														
YA5CL-90	3							.81"		X5CRT (1)	W5CVT (1)														
YA4CL-BOX	1	#4 AWG		1/4"	.50"	.81"	.09"	1.74"	Y1MR (2)	W4CVT (1)	W4CVT (1)	U4CRT (1)	Gray	8	7/8"										
YA4CL-45	2							1.44"								W4CRT (1)	W4CRT (1)								
YA4CL-90	3							.84"								X4CRT (1)	X4CRT (1)								
YA4CL1-BOX	1							8-10								.50"	.81"	.09"	1.58"	MY29-11 (1)	X4CRT (1)	X4CRT (1)	U6CABT (1)		
YA4CL1-45	2			1.28"	Y644M (1)	W3CRT (1)	W3CRT (1)												U3CRT (1)						
YA4CL1-90	3			.75"																					
YA4CL3-BOX	1			5/16"	.58"	.81"	.08"	1.92"								MY29-3 (1)	W2CVT (1)	W2CVT (1)	U2CRT (1)						
YA4CL3-45	2							1.68"												Y644M (1)	W2CRT (1)	W2CRT (1)			
YA4CL3-90	3							.96"																	
YA4CL4-BOX	1			3/8"	.58"	.81"	.08"	1.92"								MY29-11 (1)	X2CRT (1)	X2CRT (1)	U2CRT (1)						
YA4CL4-45	2							1.68"																	
YA4CL4-90	3							1.08"																	
YA4CL6-BOX	1	1/2"	.71"	.81"	.06"	2.20"	MRC840 (1)	W1CVT (1)	W1CVT (1)	U1CRT-1 (1)															
YA4CL6-45	2					2.02"					Y644M (1)	W1CRT-1 (1)	W1CRT-1 (1)												
YA4CL6-90	3					1.32"																			
YA3CL	1	# 3 STR # 2 SOL	25	5/16"	.55"	.88"	.09"	1.88"	Y2MR (2)	X1CRT-1 (1)	X1CRT-1 (1)	U4CABT (1)	Green	11	15/16"										
YA3CL-45	2							1.76"																	
YA3CL-90	3							.98"																	
YA2CL2-BOX	1	#2 AWG	35	1/4"	.61"	.88"	.11"	1.88"	Y1MR (2)	W2CVT (1)	W2CVT (1)	U2CRT (1)	Brown	10	15/16"										
YA2CL2-45	2							1.55"								MY29-3 (1)	W2CRT (1)	W2CRT (1)							
YA2CL2-90	3							.89"											Y644M (1)	X2CRT (1)	X2CRT (1)				
YA2CL-BOX	1							1.93"																	
YA2CL-45	2			1.62"																					
YA2CL-90	3			1.01"																					
YA2CL4-BOX	1			5/16"	.61"	.88"	.11"	2.06"											MY29-11 (1)	X1CRT-1 (1)	X1CRT-1 (1)	U1CRT-1 (1)			
YA2CL4-45	2							1.74"															Y644M (1)	W1CRT-1 (1)	W1CRT-1 (1)
YA2CL4-90	3							1.14"																	
YA2CL6-BOX	1			3/8"	.61"	.88"	.11"	2.06"											MRC840 (1)	X1CRT-1 (1)	X1CRT-1 (1)	U4CABT (1)			
YA2CL6-45	2							2.32"																	
YA2CL6-90	3							1.14"																	
YA1CL2	1	#1 AWG	50	1/4"	.68"	.88"	.10"	1.81"	Y1MR (2)	W1CVT (1)	W1CVT (1)	U1CRT-1 (1)	Green	11	15/16"										
YA1CL2-45	2							1.70"								MY29-3 (1)	W1CRT-1 (1)	W1CRT-1 (1)							
YA1CL2-90	3							.91"											Y644M (1)	X1CRT-1 (1)	X1CRT-1 (1)				
YA1CL-BOX	1							1.94"																	
YA1CL-45	2			1.82"																					
YA1CL-90	3			1.03"																					
YA1CL4-BOX	1			5/16"	.68"	.88"	.01"	2.06"											MY29-11 (1)	X1CRT-1 (1)	X1CRT-1 (1)	U4CABT (1)			
YA1CL4-45	2							1.95"																	
YA1CL4-90	3							1.16"																	
YA1CL6-BOX	1			3/8"	.68"	.88"	.10"	2.06"											MRC840 (1)	X1CRT-1 (1)	X1CRT-1 (1)	U4CABT (1)			
YA1CL6-45	2							2.37"																	
YA1CL6-90	3							1.40"																	

* Use PUADP-1 adapter with "U" dies in Y46 HYPRESS™.
** P-RT die sets for use in Y46 HYPRESS™ only, PUADP-1 adapter not required.

*** The MM² conductor sizes listed are the recommendations for Class 2 conductor.
▲ See tooling section of this catalog for complete tool and die listings.

◆ For applications greater than 2000 Volts, consult cable manufacturer for voltage stress relief instructions.