

Performance

The terminals and splices in this catalog are approved, per MIL-T-7928 and/or UL 486, where indicated. Table 1 shows the performance requirements for terminals used in military and commercial equipment. The voltage drops listed are maximum allowable values taken at currents well above rated current for the wires. Tensile values assure that the wires will not become separated from the terminals under reasonably expected stresses. UL tensile values are chosen to reflect the severest expected duty. MIL Specification tensile values apply only to crimp terminations and reflect minimum values that are obtained in good crimp joints. Actual performance of Burndy terminals exceeds the requirements of Table 1. Typical values are shown in Figs. 1-5. For High Temperature application BURNDY® YAV series with nickel plating "-NK" suffix provide for continuous operation to 650° F and 750° F intermittent service.

Table 1

PERFORMANCE REQUIREMENTS - TERMINALS FOR COPPER WIRE					
WIRE SIZE	PER MIL-T-7928			PER UL 486	
	TEST CURRENT (Amps)	MAX. VOLTAGE DROP (Mv)	MIN. TENSILE STRENGTH (Lbs.)	MIN. TENSILE STRENGTH (Lbs.)	TEST CURRENT FOR MAX. 50°C RISE (Amps)
26	3	8	7	—	—
24	4.5	8	10	—	—
22	9	7	15	8	—
20	11	6	19	13	—
18	16	5	38	20	—
16	22	7	50	30	—
14	32	6	70	50	15
12	41	5	110	70	20
10	55	5	150	80	30
8	73	5	225	90	50
6	101	5	300	100	65
4	135	5	400	140	85
2	181	5	550	180	115
1	211	5	650	200	130
0	245	5	700	250	150
00	283	5	750	300	175
000	320	5	825	350	200
0000	380	5	875	450	230

Fig 1. Tensile strength of YAD HYLUG™ after axial rotation stresses.

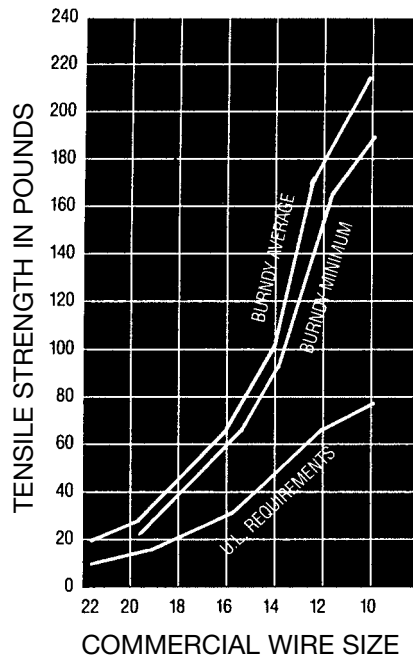
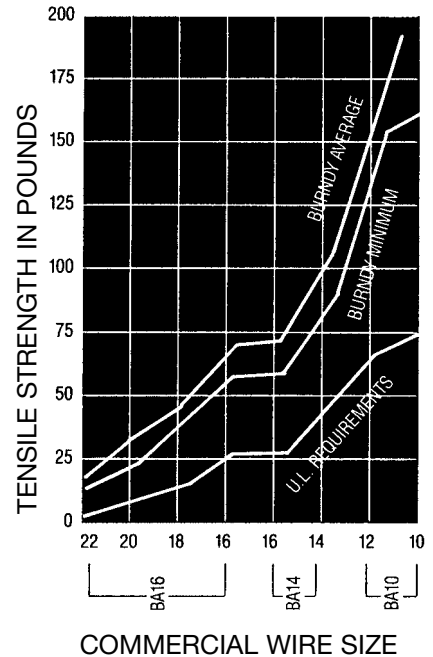

Fig 2. Tensile strength of BA VINYLUG™ after axial rotation stresses.



Throughout the catalog you will notice blue highlighted items. These are the most frequently ordered BURNDY® Products.

GENERAL INFORMATION

(Continued)

Fig 3. Tensile strength of YAES INSULUG™ after vibration.

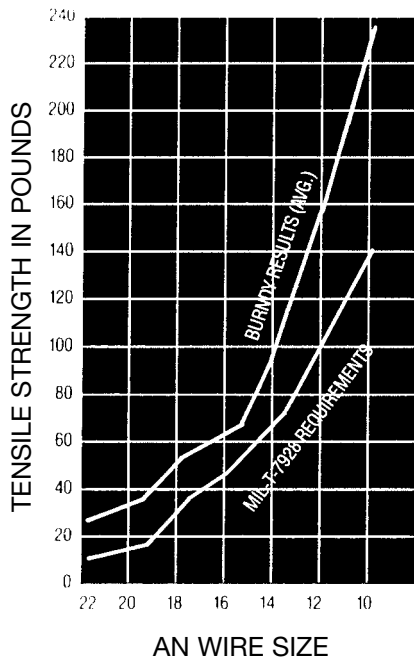

Fig 5. Voltage drops of YAES at currents per Table 1 after vibration.

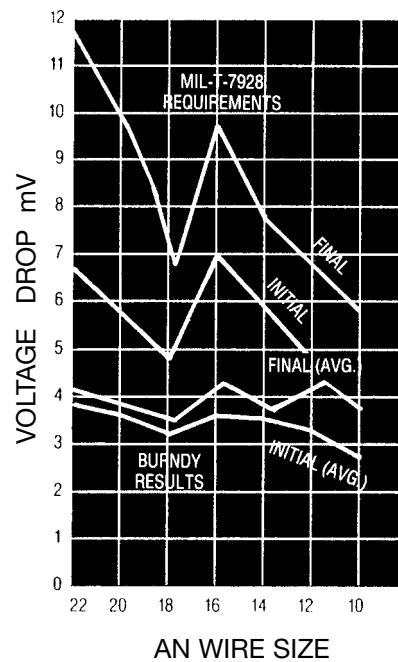
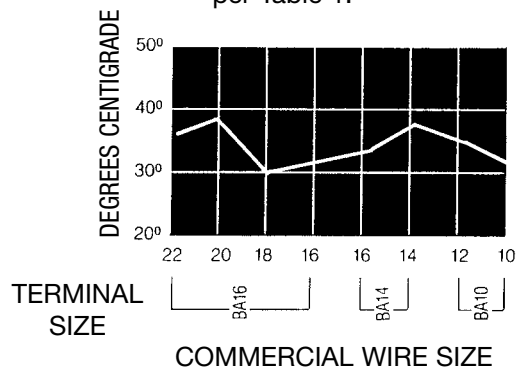

Fig 4. Temperature rise of BA VINYLUG™ at currents per Table 1.



Throughout the catalog you will notice blue highlighted items. These are the most frequently ordered BURNDY® Products.

EQUIVALENT TABLES

MILITARY SPECIFICATIONS

Terminals

Terminals

BURNDY® Equivalents to MS25036 in accordance with Specification MIL-T-7928 (ASG)

BURNDY® Equivalents to MS20659 in accordance with Specification MIL-T-7928 (ASG)

MS25036 Dash No.	Catalog Number	Class 1	Class 2	Cage Code	MS25036 Dash No.	Catalog Number	Class 1	Class 2	Cage Code	MS20659 Dash No.	Catalog Number	Class 1	Class 2	Cage Code	MS20659 Dash No.	Catalog Number	Class 1	Class 2	Cage Code
101	YAES18-N1	X	X	1NJK8	124	YAEV4C-L4	X		1NJK8	105	YAV10	X	X	1NJK8	134	YAV1C-L3	X		1NJK8
	YAE18-G43		X		125	YAEV4C-L2	X		1NJK8	106	YAV10-T2	X	X	1NJK8	135	YAV25-L3	X		1NJK8
102	YAES18-N2	X	X	1NJK8	126	YAEV2C-L1	X		1NJK8	107	YAV8C-L	X		1NJK8	136	YAV26-L3	X		1NJK8
	YAE18-N21		X		127	YAEV2C-L	X		1NJK8	108	YAV8C-L2	X		1NJK8	137	YAV28-L54	X		1NJK8
103	YAES18-N3	X	X	1NJK8	128	YAEV2C-L4	X		1NJK8	109	YAV6C-L	X		1NJK8	140	YAV8C-L14	X		1NJK8
	YAE18N		X		129	YAEV1C-L1	X		1NJK8	110	YAV6C-L2	X		1NJK8	141	YAV8C-L1	X		1NJK8
104	YAES18-N4	X	X	1NJK8	130	YAEV1C-L	X		1NJK8	111	YAV4C-L	X		1NJK8	142	YAV8C-L4	X		1NJK8
	YAE18-N3		X		131	YAEV1C-L3	X		1NJK8	112	YAV4C-L2	X		1NJK8	143	YAV6C-L10	X		1NJK8
106	YAES14-N6	X	X	1NJK8	132	YAEV25-L1	X		1NJK8	113	YAV2C-L1	X		1NJK8	144	YAV4C-L3	X		1NJK8
	YAE14-N43		X		133	YAEV25-L	X		1NJK8	114	YAV2C-L	X		1NJK8	145	YAV4C-L5	X		1NJK8
107	YAES14-N7	X	X	1NJK8	134	YAEV25-L3	X		1NJK8	115	YAV1C-L1	X		1NJK8	146	YAV2C-L3	X		1NJK8
	YAE14-N43		X		135	YAEV26-L2	X		1NJK8	116	YAV1C-L1	X		1NJK8	147	YAV2C-L2	X		1NJK8
108	YAES14-N8	X	X	1NJK8	136	YAEV26-L	X		1NJK8	117	YAV25-L1	X		1NJK8	148	YAV2C-L11	X		1NJK8
	YAE14N		X		137	YAEV26-L3	X		1NJK8	118	YAV25-L	X		1NJK8	149	YAV1C-L2	X		1NJK8
109	YAES14-N9	X	X	1NJK8	143	YAE22-G18		X	1NJK8	119	YAV26-L2	X		1NJK8	150	YAV1C-L4	X		1NJK8
	YAE14-N3		X		144	YAE22-G16		X	1NJK8	120	YAV26-L	X		1NJK8	151	YAV25-L2	X		1NJK8
110	YAE14-N4		X	1NJK8	145	YAE22-G13		X	1NJK8	121	YAV27-L	X		1NJK8	152	YAV25-L16	X		1NJK8
111	YAES10-N11	X	X	1NJK8	146	YAE22-G14		X	1NJK8	122	YAV27-L1	X		1NJK8	153	YAV26-L1	X		1NJK8
	YAE10-N5		X		147	YAE22-G15		X	1NJK8	123	YAV28-L	X		1NJK8	154	YAV26-L16	X		1NJK8
112	YAES10-N12	X	X	1NJK8	148	YAES18-N48	X	X	1NJK8	124	YAV28-L12	X		1NJK8	155	YAV27-L20	X		1NJK8
	YAE10N		X			YAE18-N17	X	X		128	YAV10-T4	X	X	1NJK8	156	YAV27-L18	X		1NJK8
113	YAES10-N13	X	X	1NJK8	149	YAES18-N49	X	X	1NJK8	129	YAV8C-L3	X		1NJK8	157	YAV28-L56	X		1NJK8
	YAE10-N2		X			YAE18N1	X	X		130	YAV6C-L1	X		1NJK8	158	YAV28-L60	X		1NJK8
114	YAE10-N4		X	1NJK8	150	YAES18-N50	X	X	1NJK8	131	YAV6C-L4	X		1NJK8	159	YAV28-L13	X		1NJK8
115	YAEV8C-L	X		1NJK8		YAE18-N2	X	X		132	YAV4C-L4	X		1NJK8	160	YAV28-L14	X		1NJK8
116	YAEV8C-L1	X		1NJK8	152	YAES14-N52	X	X	1NJK8	133	YAV2C-L4	X		1NJK8	165	YAV10-T7	X	X	1NJK8
117	YAEV8C-L2	X		1NJK8		YAES14-N53	X	X			153	YAE14-N1	X	X					
118	YAEV8C-L3	X		1NJK8	154	YAES14-N54	X	X	1NJK8										
119	YAEV6C-L1M	X		1NJK8		YAE14-N2	X	X											
120	YAEV6C-LM	X		1NJK8															
121	YAEV6C-L4M	X		1NJK8	156	YAES10-N56	X	X	1NJK8										
122	YAEV6C-L2M	X		1NJK8		YAE10-N11	X	X											
123	YAEV4C-L	X		1NJK8	157	YAES10-N57	X	X	1NJK8										
						YAE10-N3	X	X											

Throughout the catalog you will notice blue highlighted items. These are the most frequently ordered BURNDY® Products.

TYPES T AND YAD

HYLUG™

UNINSULATED COMPRESSION TERMINAL, RING TONGUE

The Type T uninsulated terminals are constructed of pure electrolytic copper. Designed with a long brazed seam barrel, standard neck, deep V groove inner serrations and electro-tin plated. The terminals are ideal for control wiring and other standard duty applications.

The ring tongue provides a secure termination under the screw head that cannot be removed without the complete removal of the screw. Two or more terminals can easily be stacked on a common stud.

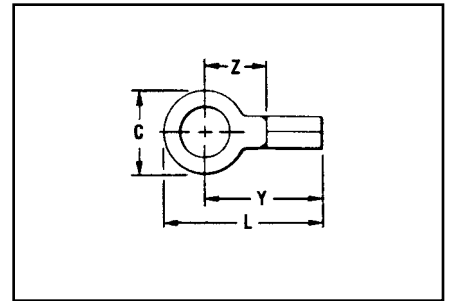
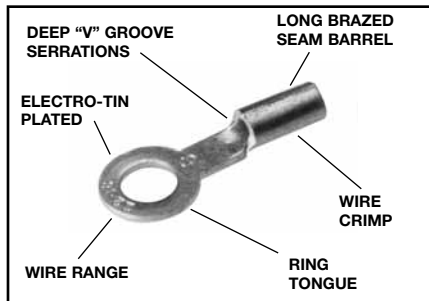

Features and Benefits

- Constructed of pure electrolytic copper.
 - ◇ Provides maximum conductivity, low resistance and ductility for excellent crimp forming properties.
- Long brazed seam barrel and deep V groove inner serrations.
 - ◇ Provides optimum conductivity reliability and holding power after crimping.
- Electro-tin plated.
 - ◇ Provides durable long-lasting corrosion resistance.
- Wire range is clearly marked on terminal.
 - ◇ Provides easy identification.
- Inspection hole.
 - ◇ Provides an easy visual check of wire insertion.
- Long neck terminal.
 - ◇ Permits easy bending and stacking of several terminals on a common stud.

Catalog Number	Wire Range	Stud Size	Dimensions				Bulk Catalog Number*	Installation Tooling	Tape Mounted Catalog Number 2000/Reel	Installation Tooling	Wire Strip Length
			C	L Max.	Y Max.	Z Min.					
T18-4	22-18	3, 4	.25	.65	.53	.24	YAD18-4	Non-Ratchet: Y10D, Y10-22 Ratchet: MR8G98, Y8MRB-1, MR20	YAD18-4M	TFM with DFM6D1 Die	9/32"
T18-6		4-6	.25	.65	.53	.24	YAD18-6		YAD18-6M		
T18-8		6-8	.31	.77	.61	.33	YAD18-8		YAD18-8M		
T18-10		8-10	.31	.77	.61	.33	YAD18-10		YAD18-10M		
T18-14		1/4	.45	.96	.73	.44	YAD18-14		YAD18-14M		
T18-516		5/16	.45	.96	.73	.44	YAD18-516		—		
T18-38	3/8	.53	1.05	.78	.49	YAD18-38	—	—	—	—	
T14-4	20-14	3, 4	.25	.67	.55	.26	YAD14-4	Non-Ratchet: Y10D, Y10-22 Ratchet: MR8G98, Y8MRB-1, MR20	YAD14-4M	TFM with DFM5D1 Die	9/32"
T14-6		4-6	.25	.67	.55	.26	YAD14-6		YAD14-6M		
T14-8		6-8	.31	.77	.61	.33	YAD14-8		YAD14-8M		
T14-10		8-10	.31	.77	.61	.33	YAD14-10		YAD14-10M		
T14-14		1/4	.45	.96	.73	.44	YD14-14		YAD14-14M		
T14-516		5/16	.45	.96	.73	.44	YAD14-516		—		
T14-38	3/8	.53	1.05	.78	.49	YAD14-38	YAD14-38M	—	—	—	
T10-6	12-10*	4-6	.37	.83	.64	.29	YAD10-6	Non-Ratchet: Y10D, Y10-22 Ratchet: MR8G98, Y8MRB-1, MR20	—	TFM with DFM4D1 Die	11/32"
T10-8		6-8	.37	.83	.64	.29	YAD10-8		*YAD10-8M		
T10-10		8-10	.37	.83	.64	.29	YAD10-10		—		
T10-14		1/4	.46	.97	.74	.39	YAD10-14		*YAD10-14M		
T10-516		5/16	.53	1.02	.76	.41	YAD10-516		*YAD10-516M		
T10-38		3/8	.58	1.08	.79	.44	YAD10-38		*YAD10-38M		

* NOTE: UL Listed for 14-10 when installed with MR8G98 and Y8MRB-1 tools only.
• 1000 pcs/reel.

Throughout the catalog you will notice blue highlighted items. These are the most frequently ordered BURNDY® Products.

B-6

TYPES TP AND BA

VINYLUG™

TERMINAL -
POLYVINYLCHLORIDE
INSULATED, RING TONGUE

600 VOLTS MAX., 105° C MAX.

VINYLUG™ Type TP is designed for commercial and light duty industrial control and power circuit applications. Supplied with an expanded polyvinyl chloride (PVC) insulation shroud, many tongue variations and rated 600V makes TP terminals versatile and economical.

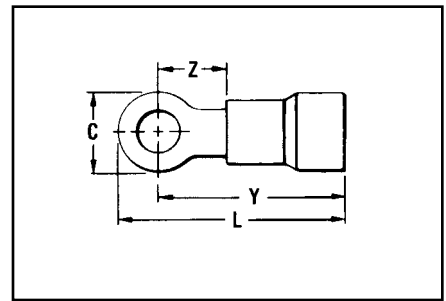
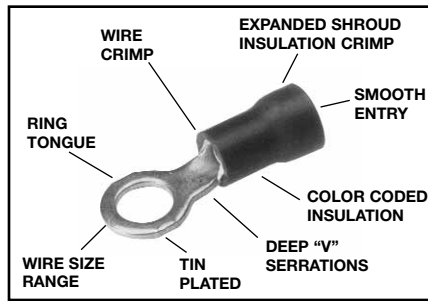

Features and Benefits

- Expanded insulation support accepts standard and large wire diameters.
 - ◇ Lowers inventory requirements, permits greater flexibility and provides insulation support.
- Funnel entry.
 - ◇ Easy wire insertion.
- Manufactured of pure electrolytic copper.
 - ◇ Provides maximum conductivity, low resistance and ductility for excellent crimp forming properties.
- Deep V groove serrations in the inner barrel.
 - ◇ Provides added holding strength and better conductivity.
- Electro-tin plated.
 - ◇ Provides durable long-lasting corrosion resistance.

Catalog Number	Wire Range	Stud Size	Dimensions				Bulk Catalog Number*	Installation Tooling	Tape Mounted Catalog Number 2000/Reel	Installation Tooling	Wire Strip Length
			C	L	Y	Z					
TP16-4	22-16 Max. Insul. Dia. Accom.: .145 Color Code: Red	3-4	.22	.71	.61	.17	BA16E4	Plier Type: Y10-22, Y10D or Ratchet Tool: MR8-89-1, NR8-G96, MR15	BA16E4M	TFM with DFM3D-1 Die	13/64"
TP16-6		4-6	.25	.74	.62	.18	BA16E6		BA16E6M		
TP16-8		6-8	.31	.85	.70	.26	BA16E8		BA16E8M		
TP16-10		8-10	.31	.85	.70	.26	BA16E10		BA16E10M		
TP16-14		12, 1/4	.40	.99	.79	.36	BA16E14		BA16E14M		
TP16-38		3/8	.53	1.15	.88	.45	BA16E38		BA16E38M		
TP14-4	16-14 Max. Insul. Dia. Accom.: .180 Color Code: Blue	3-4	.22	.71	.61	.17	BA14E4		BA14E4M	TFM with DFM2D-1 Die	13/64"
TP14-6		4-6	.25	.74	.62	.18	BA14E6		BA14E6M		
TP14-8		6-8	.31	.85	.70	.26	BA14E8		BA14E8M		
TP14-10		8-10	.31	.85	.70	.26	BA14E10		BA14E10M		
TP14-14		12, 1/4	.40	.99	.79	.36	BA14E14		BA14E14M		
TP14-516		5/16	.53	1.15	.88	.45	BA14E516		BA14E516M		
TP14-38	3/8	.53	1.15	.88	.45	BA14E38	—				
TP10-6	12-10 Max. Insul. Dia. Accom.: .260 Color Code: Yellow	4-6	.31	.91	.75	.20	BA10E6	*BA10E6M	TFM with DFM1D5 Die	19/64"	
TP10-8		6-8	.36	1.00	.81	.26	BA10E8	*BA10E8M			
TP10-10		8-10	.36	1.00	.81	.26	BA10E10	*BA10E10M			
TP10-14		12, 1/4	.53	1.22	.95	.40	BA10E14	*BA10E14M			
TP10-38		3/8	.53	1.27	1.00	.45	BA10E38	*BA10E38M			

* 1000/Reel

Throughout the catalog you will notice blue highlighted items. These are the most frequently ordered BURNDY® Products.

TYPE YAE-G BOX

INSULUG™

TERMINAL -
 NYLON INSULATED,
 RING-TONGUE
 MULTI-FINGER
 INSULATION GRIP

300 VOLTS MAX., 105° C MAX.

INSULUG™ Type YAE-N nylon insulated terminals are designed with a multi-finger insulation grip for paper, EPR and other elastic or hard to grip insulations. The metal fingers firmly grip the insulation providing superior holding characteristics, cable support and strain relief. Type YAE-N terminals are rated 105°C and meet military standard MS25036 class 2 and MIL-T-7928 (ASG) requirements.

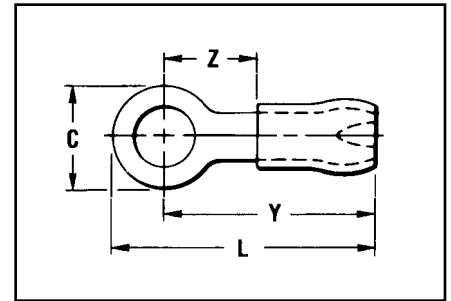
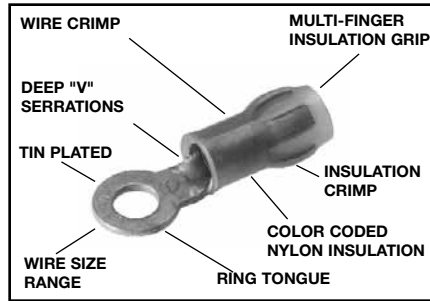

Features and Benefits

- Multi-finger insulation grip.
 - ◇ Provides superior insulation holding characteristics, especially on EPR and other elastic-type insulations.
- Brazed seam.
 - ◇ Provides stronger more durable termination.
- Manufactured of pure electrolytic copper.
 - ◇ Provides maximum conductivity, low resistance and ductility for excellent crimp forming properties.
- Deep V groove, inner barrel serrations.
 - ◇ Provide optimum conductivity, reliability, and holding power.
- Smooth funnel entry.
 - ◇ Easy wire insertion.



Catalog Number	Wire Range	Stud Size	Mil. Std.** MS25036	Dimensions				Bulk Catalog Number*	Installation Tooling	Tape Mounted Catalog Number 2000/Reel	Installation Tooling	Wire Strip Length
				C	L Max.	Y Max.	Z Max.					
YAE22G18 BOX•	26-20	1.2	-148	.15	.70	.62	.22	YAE22G18•	M8ND with N14HET-25V1 Die	YAE22G18M•	TFM with DFM11D1 Die	5/32"
YAE22G12 BOX•	Max. Insul.	1.2	—	.25	.75	.62	.22	YAE22G12•		—		
YAE22G16 BOX•	Dia. Accom.: .098	3.4	-144	.18	.75	.62	.22	YAE22G16•		YAE22G16M•		
YAE22G13 BOX•		4-6	-145	.25	.75	.62	.22	YAE22G13•		YAE22G13M•		
YAE22G14 BOX•	Color Code:	6-8	-146	.32	.83	.67	.27	YAE22G14•		—		
YAE22G15 BOX•	Amber	8-10	-147	.32	.83	.67	.27	YAE22G15•		—		

• Not UL recognized
 * 1000/Box
 ** Class 2

Throughout the catalog you will notice blue highlighted items. These are the most frequently ordered BURNDY® Products.

B-10

TYPES YAE-N BOX AND YAE
(Continued)

INSULUG™

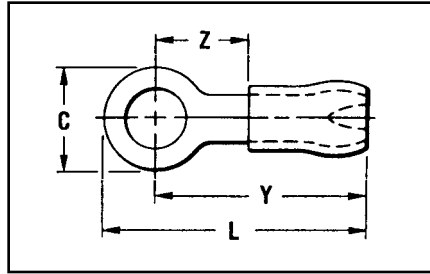

Catalog Number	Wire Range	Stud Size	Mil Std.** MS25036	Dimensions				Bulk Catalog Number	Installation Tooling	Tape Mounted Catalog Number 2000/Reel	Installation Tooling	Wire Strip Length
				C	L Max.	Y Max.	Z Min.					
YAE18N29 BOX	22-16 † Max. Insul. Dia. Accom.: .125 Color Code: Red	1-2	—	.14	.75	.68	.19	YAE18N29	MR8-33T-1 (no extra dies required) M8ND with one of following dies: N14HET-25V1 N10ET-9 N14HET-15 or Y10D Y10-22	YAE18N29M	TFM with DFM10D1 die	3/16"
YAE18N27 BOX		2	—	.19	.77	.66	.19	YAE18N27		YAE18N27M		
—		4	—	.25	.80	.68	.19	YAE18-N7		YAE18-N7M		
—		4	-148	.25	.80	.68	.19	YAE18N17		—		
—		4	—	.23	.78	.68	.19	YAE18N26		YAE18N26M		
YAE18N21 BOX		4-6	-102	.25	.89	.77	.28	YAE18N21		YAE18N21M		
—		4-6	—	.22	.79	.68	.19	YAE18N25		YAE18N25M		
YAE18G43 BOX		4-6	—	.25	.90	.68	.19	YAE18G43		YAE18G43M		
YAE18N24 BOX		6-8	—	.28	.92	.77	.28	YAE18N24		YAE18N24M		
YAE18N1 BOX		6-8	-149	.31	.92	.77	.28	YAE18N1		YAE18N1M		
YAE18N BOX		8-10	-103	.31	.92	.77	.28	YAE18N		YAE18NM		
YAE18N2 BOX		12, 1/4	-150	.45	1.11	.88	.40	YAE18N2		YAE18N2M		
YAE18N3 BOX		5/16	-104	.45	1.11	.88	.40	YAE18N3		YAE18N3M		
YAE14N43 BOX		16-14 Max. Insul. Dia. Accom.: .156 Color Code: Blue	4-6	-106	.25	.82	.69	.20		YAE14N43		
YAE14N1 BOX	6-8		-153	.31	.92	.75	.28	YAE14N1	YAE14N1M			
YAE14N BOX	8-10		-108	.31	.92	.75	.28	YAE14N	YAE14NM			
YAE14N2 BOX	1/4		-154	.45	1.11	.88	.40	YAE14N2	YAE14N2M			
YAE14N3 BOX	5/16		-109	.45	1.11	.88	.40	YAE14N3	YAE14N3M			
YAE14N4 BOX	3/8		-110	.53	1.19	.93	.44	YAE14N4	YAE14N4M			
—	14-12 Max. Insul. Dia. Accom.: .180 Color Code: Green	10	—	.31	1.06	.93	.29	YAE12N7	—	TFM with DFM7D1 die	21/64"	
YAE12N9 BOX		6-8	—	.31	1.06	.90	.28	YAE12N9	YAE12N9M			
YAE12N1 BOX		6-8	—	.31	1.06	.90	.28	YAE12N1	YAE12N1M			
YAE12N BOX		8-10	—	.31	1.06	.90	.28	YAE12N	YAE12NM			
YAE12N2 BOX	1/4	—	.46	1.25	1.02	.40	YAE12N2	YAE12N2M				
YAE10N5 BOX	12-10 Max. Insul. Dia. Accom.: .209 Color Code: Yellow	4-6	-111	.38	1.15	.96	.28	YAE10N5	* YAE10N5M	TFM with DFM7D1 die	3/8"	
YAE10N11 BOX		6-8	-156	.38	1.17	.98	.30	YAE10N11	* YAE10N11M			
YAE10N BOX		8-10	-112	.38	1.15	.96	.28	YAE10N	* YAE10NM			
YAE10N3 BOX		1/4	-157	.54	1.39	1.12	.44	YAE10N3	* YAE10N3M			
YAE10N2		5/16	-113	.54	1.39	1.12	.44	YAE10N2	* YAE10N2M			
YAE10N4		3/8	-114	.54	1.39	1.12	.44	YAE10N4	* YAE10N4M			

* 1000/Box
** Class 2
† Use Y10D or Y10-22 only when crimping #16 AWG.

Throughout the catalog you will notice blue highlighted items. These are the most frequently ordered BURNDY® Products.

TYPES YAV BOX AND YAV

HYLUG™

SEAMLESS UNINSULATED COMPRESSION HEAVY DUTY RING TONGUE TERMINAL

#22-10 STRANDED AND SOLID COPPER

HYLUG™ type YAV is a seamless, heavy duty uninsulated compression ring tongue terminal manufactured from pure electrolytic copper tubing and is for use on copper commercial (code) cable, type AN aircraft cable and extra flexible conductors. Because of its seamless design, the YAV HYLUG™ also accommodates solid conductors.

The seamless tubing produces a double thick tongue and a strong connector for demanding applications that require high reliability. Applications include industrials, hospitals, electric utilities, aircraft, shipboard and marine, computers, steel mills, mining equipment and other equipment that is subject to vibration or requiring dependable electrical performance.

The YAV-HYLUG™ terminals meet the requirements of MIL-T-7928 (ASG).

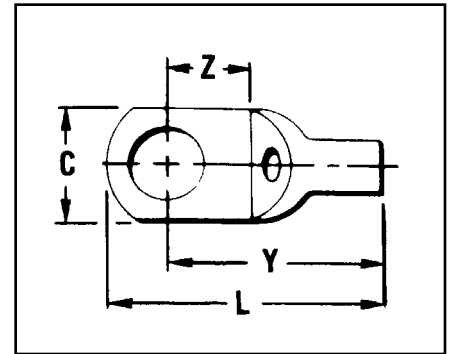
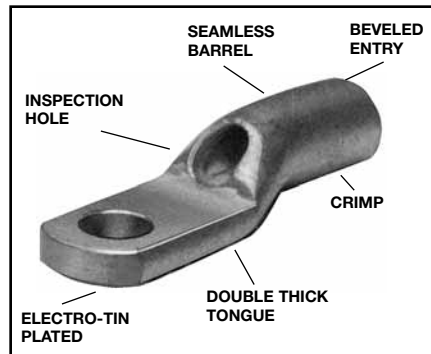

(See table on following page for specifications)

Features and Benefits

- Manufactured from seamless pure electrolytic copper tubing.
 - ◇ Provides maximum conductivity, low resistance and excellent ductility for crimping.
- Seamless tubular crimp barrel design.
 - ◇ No seams to split resulting in a very high quality electrical connection. Also can be used on solid conductor.
- Double thick tongue.
 - ◇ Provides a very strong terminal tongue.
- Produced from tubular copper.
 - ◇ Extra copper material assures the compression connector will operate cooler than the conductors it connects.
- Internally bevelled barrel.
 - ◇ Provides easy cable entry, especially for flexible conductors.
- Inspection hole.
 - ◇ Provides easy visual check for proper conductor insertion.
- Electro-tin plated.
 - ◇ Provides long lasting durable corrosion resistance.
- Nickel plating available, add "NK" suffix."
 - ◇ Nickel plated HYLUGs™ provide high temperature applications up to 650° F continuous service and 750° F intermittent service.

B-14

TYPES YAV BOX AND YAV

HYLUG™

SEAMLESS UNINSULATED COMPRESSION HEAVY DUTY RING TONGUE TERMINAL

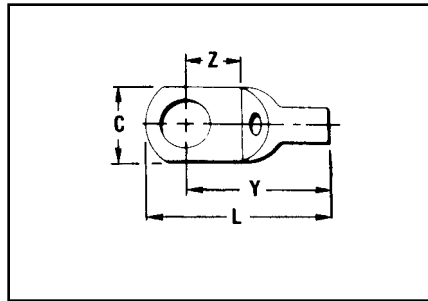

Catalog Number	Wire Range	Stud Size	Dimensions				Bulk Catalog Number	Installation Tooling	Wire Strip Length
			C	L Max.	Y Max.	Z Min.			
YAV18-T4 BOX	22-18 Str. and Sol.	3, 4	.19	.62	.54	.16	YAV18-T4	Non-Ratchet: Y10D, Y10-22 Ratchet: MR8G98, MR8-9Q, Y8MRB-1, MR20	9/32"
YAV18-L33 BOX		4-6	.25	.67	.55	.18	YAV18-L33		
YAV18-T5 BOX		4-6	.31	.76	.61	.24	YAV18-T5		
YAV18-T1 BOX		6-8	.31	.76	.61	.24	YAV18-T1		
YAV18 BOX		8-10	.31	.76	.61	.24	YAV18		
YAV14-L33 BOX	20-14 Str.	4-6	.25	.71	.59	.18	YAV14-L33	Non-Ratchet: Y10D, Y10-22 Ratchet: MR8G98, MR8-9Q, Y8MRB-1, MR20	9/32"
YAV14-T5 BOX		4-6	.31	.79	.64	.24	YAV14-T5		
YAV14-T1 BOX		6-8	.31	.79	.64	.24	YAV14-T1		
YAV14-L36 BOX	20-12 Sol.	8-10	.29	.74	.59	.18	YAV14-L36	Non-Ratchet: Y10D, Y10-22 Ratchet: MR8G98, MR8-9Q, Y8MRB-1, MR20	9/32"
YAV14 BOX		8-10	.31	.79	.64	.24	YAV14		
YAV14-T2 BOX		1/4	.42	.99	.75	.32	YAV14-T2		
YAV14-T3 BOX	14-12 Str.	5/16	.44	.99	.75	.32	YAV14-T3	Y10D, Y8MRB-1 M8ND w/N14HT	9/32"
YAV12-G2 BOX ■		8-10	.30	.82	.67	.24	YAV12-G2		
YAV12-G3 BOX ■		1/4	.36	1.00	.76	.34	YAV12-G3		
YAV10-T7 BOX	†14 Str. 12-10 Str. and Sol.	4-6	.30	.93	.78	.24	YAV10-T7	Non-Ratchet: Y10, Y10-22 Ratchet: MR8G98, MR8-9Q, Y8MRB-1, MR20	7/16"
YAV10-T11 BOX		6-8	.38	.97	.79	.26	YAV10-T11		
YAV10-L36 BOX		8-10	.29	.86	.71	.23	YAV10-L36		
YAV10 BOX		8-10	.38	.97	.79	.26	YAV10		
YAV10-T3 BOX		1/4	.47	1.10	.87	.32	YAV10-T3		
YAV10-T2 BOX		5/16	.53	1.13	.87	.31	YAV10-T2		
YAV10-T4 BOX		3/8	.56	1.18	.90	.35	YAV10-T4		
YAV9C-L36 BOX	10-9 Str.	8-10	.31	.97	.83	.15	YAV9C-L36	Ratchet: MR8-9Q, Y8MRB-1	7/16"
YAV9C-T9 BOX		1/4	.44	1.19	.95	.31	YAV9C-T9		
YAV9C-T4 BOX		5/16	.52	1.27	1.02	.36	—		

■ Use #14 groove
 † UL listed for 14 Str. to #10 Sol. & Str. when installed with MR8G98 and Y8MRB-1 tools only.

Throughout the catalog you will notice blue highlighted items. These are the most frequently ordered BURNDY® Products.