

Application Notes

Resistor Terminals for Tubular Cores

TYPE 57

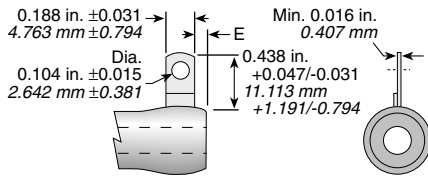

TYPE 47 AND 48

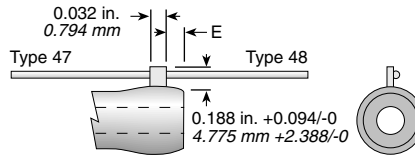

TYPE 48R

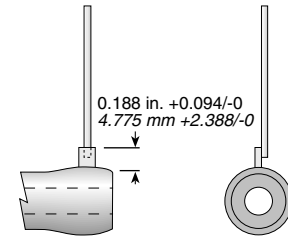

TYPE 40 AND 40A

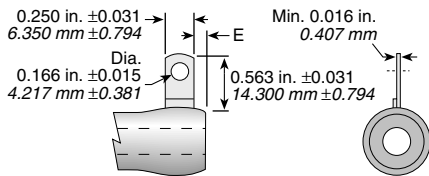

TYPE 44, 44A, 45, 45A, 45B

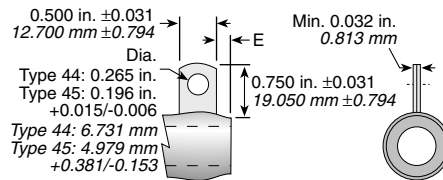

TYPE 58

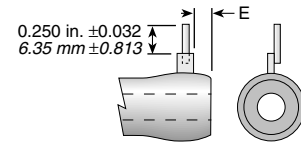

TYPE 46 AND 46A

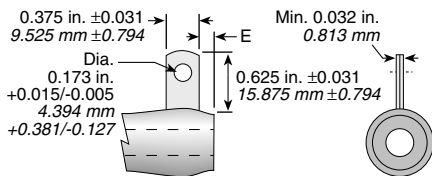

TYPE 538

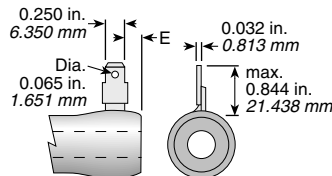

TYPE 126 AND 126R

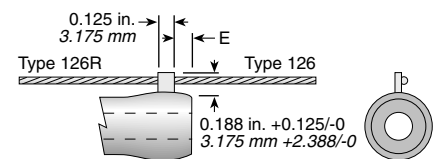

TYPE 535

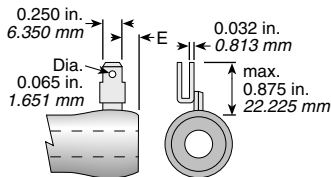

TYPE 532

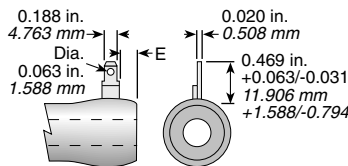

OTHER TERMINALS

Type 49

.250 (6.35mm) wide x
0.313 (7.950mm)
.166 (4.217mm) dia.
hole. Solder coated.

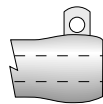

Type 51

.125 (3.175mm) wide
x height as specified.
0.072 (1.829mm) hole.
Solder coated.

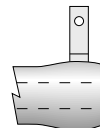

Type 68

.188 (4.775mm) wide
x 0.531 (13.488mm)
high. Solder coated.

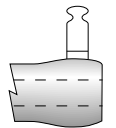

Type 50

Untinned lug intended for
welded connection.
0.063 (1.600mm) x
height as specified.

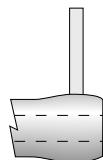

Type 52

For "wire wrap" (Keller,
Gardner-Denver T.M.)

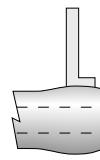

Type 69

.125 (3.175mm) wide
x 0.375 (9.525mm)
high. Solder coated.

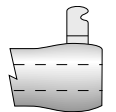

(continued)

Application Notes

Resistor Terminals for Tubular Cores

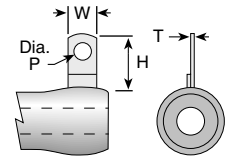

TERMINAL DIMENSIONS

Terminal Type	W		H		T		P		Core Diameter Range	
	in.	(mm)	in.	(mm)	in.	(mm)	in.	(mm)	in.	(mm)
40, 40A	0.25 ± 0.031	(6.35 ± 0.794)	0.563 ± 0.031	(14.3 ± 0.794)	min 0.016	(0.407)	0.166 ± 0.015	(4.217 ± 0.381)	0.313-1.125	(7.95-28.575)
44, 44A	0.5 ± 0.031	(12.7 ± 0.794)	0.750 ± 0.031	(19.05 ± 0.794)	min 0.032	(8.13)	0.265 +0.015/-0.006	(6.731 +0.381/-0.153)	0.75-1.125	(19.05-28.575)
45, 45A, 45B	0.5 ± 0.031	(12.7 ± 0.794)	0.750 ± 0.031	(19.05 ± 0.794)	min 0.032	(8.13)	0.196 +0.015/-0.006	(4.979 +0.381/-0.153)	0.75-1.125	(19.05-28.575)
46, 46A	0.375 ± 0.031	(9.525 ± 0.794)	0.625 ± 0.031	(15.875 ± 0.794)	min 0.032	(8.13)	0.173 +0.015/-0.005	(4.394 +0.381/-0.127)	0.563-1.50	(14.3-38.1)
47, 48, 48R	0.125 ± 0.031	(3.175 ± 0.794)	0.188 +0.094/-0	(4.775+2.38/-0)	N/A		N/A		0.0210-0.563	(5.25-14.3)
57	0.188 ± 0.031	(4.763 ± 0.794)	0.438 +0.047/-0.031	(11.113 +1.191/-0.794)	min 0.016	(0.407)	N/A		0.25-0.75	(6.35-19.05)
58	0.125 ± 0.031	(3.175 ± 0.794)	0.188 +0.094/-0	(4.775+2.38/-0)	N/A		N/A		0.0210-0.563	(5.25-14.3)
126, 126R	0.125 ± 0.031	(3.175 ± 0.794)	0.188 +0.094/-0	(4.775+2.38/-0)	N/A		N/A		0.313-1.125	(7.95-28.575)
532	0.188 ± 0.031	(4.763 ± 0.794)	0.469 +0.063/-0.031	(11.906 +1.588/-0.794)	0.020	(0.508)	0.063	(1.588)	0.313-1.125	(7.95-28.575)
535	0.25 ± 0.031	(6.35 ± 0.794)	max 0.875	(22.225)	0.032	(8.13)	0.065	(1.651)	0.313-2.5	(7.95-63.5)
538	0.25 ± 0.031	(6.35 ± 0.794)	max 0.844	(21.438)	0.032	(8.13)	0.065	(1.651)	0.313-2.5	(7.95-63.5)

40A- Has screw #6-32 x .5 with 2 nuts and washers

44A- Has screw 20 x .625 with 2 nuts and washers

45A- Has screw #8-32 x .625 with 2 nuts and washers

45B- Has screw #10-32 x .625 with 2 nuts and washers

46A- Has screw #8-32 x .625 with 2 nuts and washers

EDGE DISTANCE—DIMENSION “E”

Terminals	in.		mm		in.		mm		in.		mm		in.		mm		in.		mm		
	.250	6.350	.313	7.938	.438	11.113	.563	14.288	.750	19.050	1.00	25.40	1.125	28.575	1.500	38.100	1.625	41.275	2.500	63.500	
40-40A-49-50-																					
57-68-69-126-	.031	.794	.094	2.381	.094	2.381	.094	2.381	.125	3.175	.156	3.969	.219	5.556	—	—	—	—	—	—	—
126R-532																					
44-44A-45-45A-	—	—	—	—	—	—	.250	6.350	.250	6.350	.250	6.350	.250	6.350	—	—	—	—	—	—	—
45B-46-46A																					
535-538	—	—	.125	3.175	.125	3.175	.125	3.175	.125	3.175	.156	3.969	.219	5.556	.250	6.350	.250	6.350	.500	12.700	

Dimension “E” can be varied and is often reduced for cores 2.00 (50.80mm) or less in length or sometimes increased for greater leakage distance to ground. Tolerance on “E” is ± 0.016 (.397mm) up to 0.125 (3.175mm) and ± 0.063 (1.588mm) above.

TYPE 140

For Cores 0.438 (11.113mm) to 1.125 (28.575mm) O.D.

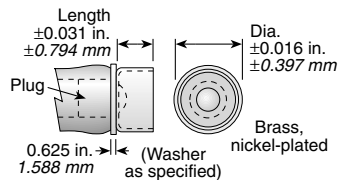

Ferrule				Catalog No.	
Diameter	Length	No Washer	With Washer		
In.	mm	In.	mm		
.563	14.288	.500	12.700	140/9*	140/19
.688	17.463	.563	14.288	140/11*	140/01
.813	20.638	.500	12.700	140/13†	140/03
1.125	28.575	.500	12.700		140/18

* Up thru 0.563 (14.288mm) D core.

† Up thru 0.750 (19.050mm)

TYPE 141

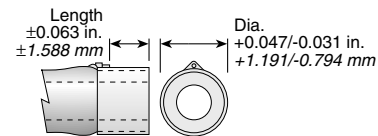

Diameter		Ferrule Length		Catalog No.	Core O.D.	
In.	mm	In.	mm		In.	mm
.625	15.875	.625	15.875	141/10	.563	14.288
.813	20.638	.688	17.463	141/13	.750	19.050
1.062	26.988	.688	17.463	141/17	1.000	25.400
1.188	30.163	.688	17.463	141/19	1.125	28.575

Ferrules are brass, natural finish.

TYPE 63

Cores 0.563 (14.288mm) to 0.750 (19.050mm) O.D. --- Cat No. 63/12

Cores 1.000 (25.400mm) to 1.125 (28.575mm) O.D. --- Cat No. 63/18

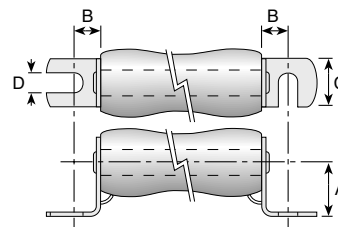

Cat. No.	A		B		C		D (Min.)	
	±.031 In.	(.794 mm)	±.031 In.	(.794 mm)	±.031 In.	(.794 mm)	In.	mm
63/12	.781	19.844	.438	11.113	.750	19.050	.250	6.350
63/18	.875	22.225	.813	20.638	1.125	28.575	.313	7.938

**Check product availability
using the Worldwide Inventory
Search at ohmite.com**