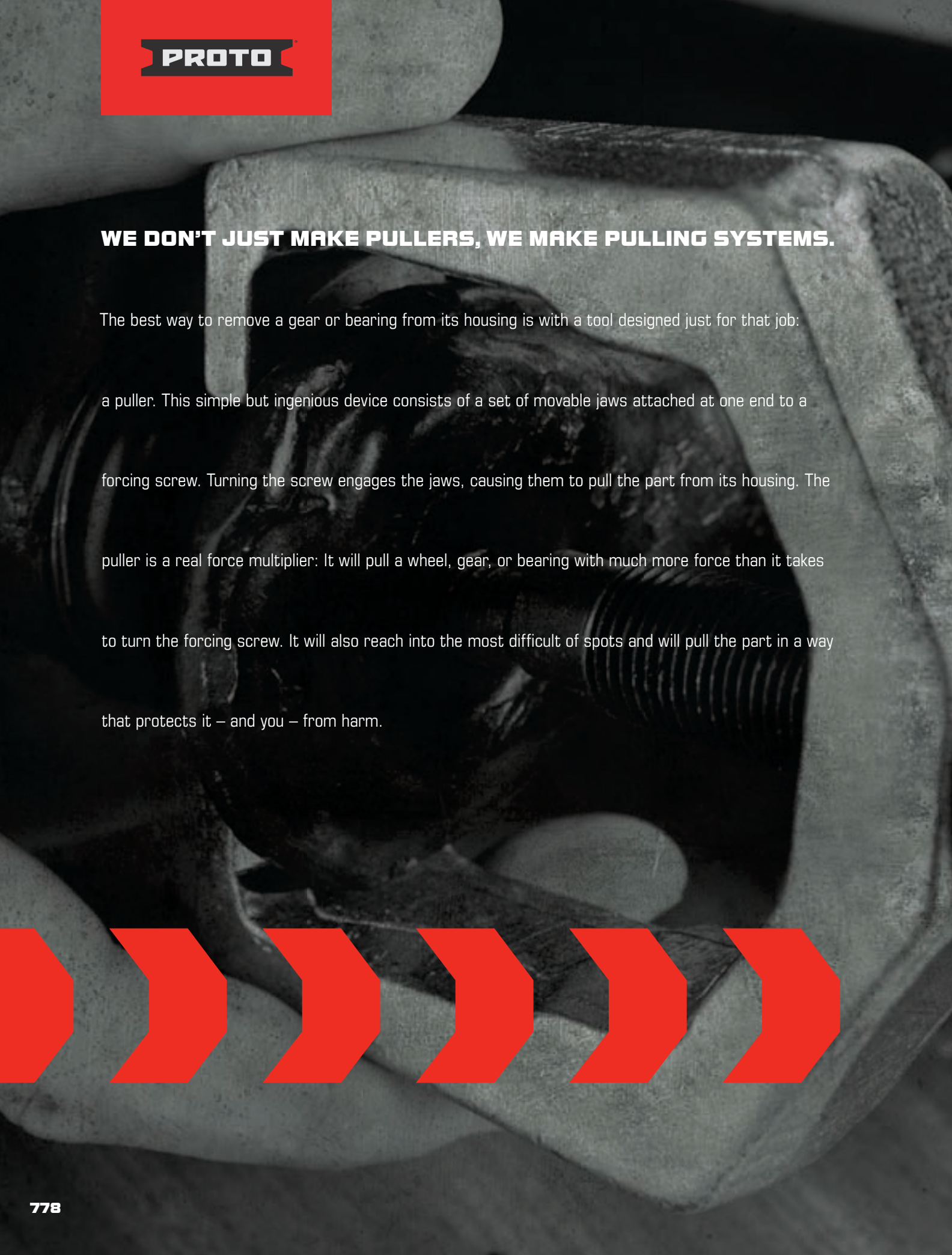

WE DON'T JUST MAKE PULLERS, WE MAKE PULLING SYSTEMS.

A close-up, black and white photograph showing a puller tool in the process of extracting a bearing from a metal housing. The puller's jaws are visible, gripping the inner ring of the bearing. A threaded rod is being turned, which causes the jaws to pull the bearing out of the housing. The background is dark and out of focus, emphasizing the mechanical action.

The best way to remove a gear or bearing from its housing is with a tool designed just for that job: a puller. This simple but ingenious device consists of a set of movable jaws attached at one end to a forcing screw. Turning the screw engages the jaws, causing them to pull the part from its housing. The puller is a real force multiplier: It will pull a wheel, gear, or bearing with much more force than it takes to turn the forcing screw. It will also reach into the most difficult of spots and will pull the part in a way that protects it – and you – from harm.

PROTO-EASE™ GEAR AND BEARING SEPARATOR

Product #: **J4332**

- › Capacity: 4-3/8".
- › Weight (lbs): 5.57

Contents	Description	Qty.
J4332N	Hex Nut, 5/8"-18 UNF	4
J4332P	Separator Plate, Size #2	2
J4332R	Threaded Rod, 5/8"-18 UNF	2

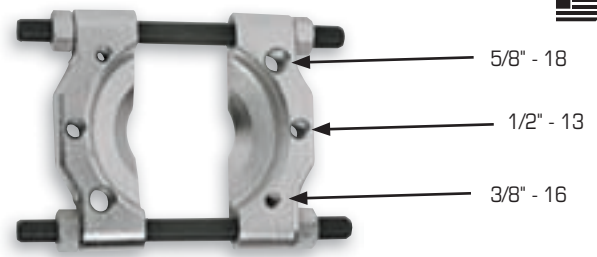

PROTO-EASE™ GEAR AND BEARING SEPARATOR

Product #: **J4333**

- › Capacity: 6".
- › Weight (lbs): 11.75

Contents	Description	Qty.
J4333N	Hex Nut, 3/4"-16 UNF	4
J4333P	Separator Plate, Size #3	2
J4333R	Threaded Rod, 3/4"-16 UNF x 10"	2

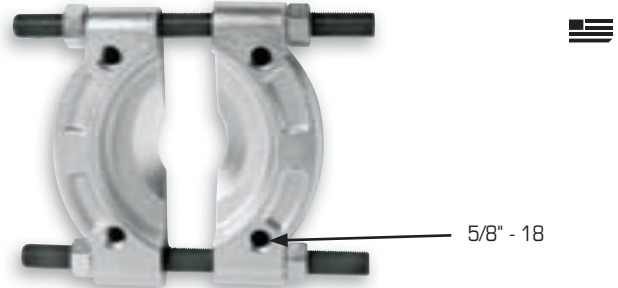

PROTO-EASE™ GEAR AND BEARING SEPARATOR

Product #: **J4333A**

- › Capacity: 6".
- › Weight (lbs): 12.50

Contents	Description	Qty.
J4333N	Hex Nut, 3/4"-16 UNF	4
J4333P	Separator Plate, Size #3	2
J4333AR	Threaded Rod, 3/4"-16 UNF x 13"	2

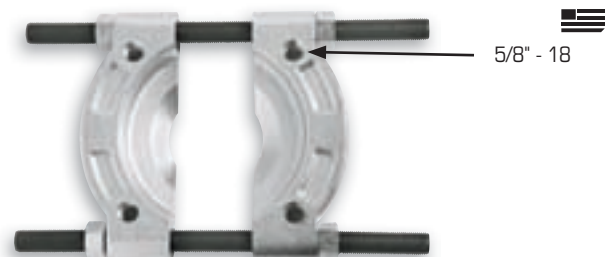

ADJUSTABLE REVERSIBLE JAW

Product #	Description	Length (in) (A)	Reach (in) (B)
J4230RJ	Adjustable Reversible Jaw	3-5/8	2-3/4

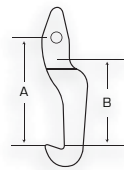

LEGS

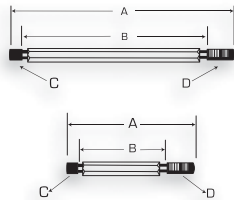

Product #	Description	Length (in) (A)	Shaft Length (in) (B)	Thread (C)	Thread (D)
J4240L	Medium Leg	14-3/16	12-19/64	1/2"-20 UNF	5/8"-18 UNF



SEPARATOR THREADED RODS

Product #	Length (in) (A)	Thread	For Separator
J4332R	8-1/2	5/8"-18 UNF	J4332
J4333R	10	3/4"-16 UNF	J4333



CROSSARM

Product #	Description	Length (in) (A)	Use with Rod Size
J4001B	Crossarm	6-5/8	1" - 8 TPI

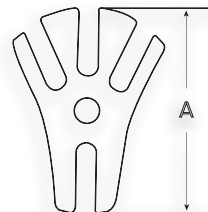

FORCING SCREW

Product #	Description	Hex Head (in)	Thread	Overall Length (in)	Detachable Tip
J4012	Forcing Screw	3/4	3/4"-10	11-13/16	J4012T



NOTE: ALL PROTO-EASE™ forcing screws are coated at the factory with the latest aerospace dry film lubricant designed to increase screw life, reduce wear and torque required for screw turning. It is recommended that a few drops of medium grade oil (SAE 30 or equivalent) be added to screw threads prior to every use. Screw threads must be kept clean at all times.