

# GRJ Conduit Outlet Boxes

## Explosionproof, Dust-Ignitionproof, Raintight

UNILETS® for use with Threaded Metal Conduit. Furnished with Internal Ground Screw.

### NEC/CEC:

Class I, Division 1 and 2, Groups C, D  
Class II, Division 1 and 2, Groups E, F, G  
Class III

### Applications

- Complies with a wide range of classified area requirements.
- Corrosion-resistant: ideal indoors or out.
- For pulling of wires.
- Connect conduit lengths and change direction of conduit runs.
- Provide access for maintenance.

### Features

- Malleable iron bodies have high tensile strength and ductility. Provides great resistance to corrosion, impact, and shock.
- Accurately tapped, tapered hub threads for tight, rigid joints and ground continuity.
- Furnished with covers.
- General purpose wiring.
- Small, round conduit outlet boxes.
- Externally threaded body with internally threaded cover.
- Smooth, rounded integral bushing in each hub type box protects conductor insulation.

### Standard Materials

- Bodies and covers: malleable iron

### Standard Finishes







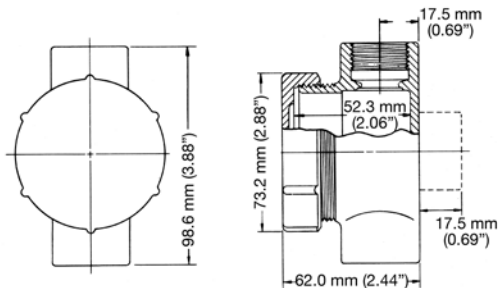

- Bodies and covers: triple-coat — (1) zinc electroplate, (2) chromate, and (3) epoxy powder coat

### NEC/CEC Certifications and Compliances

- UL Standard: UL 886 (UL 1203)
- UL Listed: E10444
- CSA Standard: C22.2 No. 25, C22.2 No. 30
- CSA Certified: 025875

### Dimensions



Box Type	Conduit Size (Inches)	Cover Opening mm (in)	Capacity dm <sup>3</sup> (in <sup>3</sup> )	Catalog Number
<b>GRJ Box with Cover</b>				
	1/2	54.1 (2.13)	0.12 (7.3)	<b>GRJC50</b>
	3/4	54.1 (2.13)	0.12 (7.3)	<b>GRJC75</b>
	1/2	54.1 (2.13)	0.12 (7.3)	<b>GRJCA50</b>
	3/4	54.1 (2.13)	0.12 (7.3)	<b>GRJCA75</b>
	1/2	54.1 (2.13)	0.12 (7.3)	<b>GRJEA50</b>
	3/4	54.1 (2.13)	0.12 (7.3)	<b>GRJEA75</b>
	1/2	54.1 (2.13)	0.12 (7.3)	<b>GRJL50</b>
	3/4	54.1 (2.13)	0.12 (7.3)	<b>GRJL75</b>
	1/2	54.1 (2.13)	0.12 (7.3)	<b>GRJT50</b>
	3/4	54.1 (2.13)	0.12 (7.3)	<b>GRJT75</b>
	1/2	54.1 (2.13)	0.12 (7.3)	<b>GRJTA50</b>
	3/4	54.1 (2.13)	0.12 (7.3)	<b>GRJTA75</b>
	1/2	54.1 (2.13)	0.12 (7.3)	<b>GRJX50</b>
	3/4	54.1 (2.13)	0.12 (7.3)	<b>GRJX75</b>
<b>GRJ Covers</b>				
	GRJ Surface Covers	54.1 (2.13)		<b>GRJK-S</b>

Enclosures and Junction Boxes

NEC/CEC CLASS/ZONE RATED HAZARDOUS LOCATION OUTLET BOXES