



Description

Amphenol 44 series connectors offer high performance at low cost for applications requiring environmentally sealed yet inexpensive connectors. 44 series connectors feature an all-resilient, one piece waterproof design incorporating crimp Poke-Home® contacts in six configurations.

Features

- **Environmental Sealing** Water-proof seals (primary, secondary and wire) prevent liquid from entering the connector or causing electric or electronic circuit failures (not intended for submersible applications).
- **High Reliability** Hooded female contacts plus a molded-in polarizing flat assures proper contact/connector alignment and eliminates the possibility of lost or cross-wire circuits.
- **Durable** The resilient connector body is abrasion resistant and impervious to water, lubricants, fuel, ozone and road salts.
- **Long Service** The unique one-piece shell and insert construction minimizes the number of parts and failure modes for predictably long service life.
- **Low Installed Cost** Punch-press contacts permit the use of automated stripping and crimping equipment for lower on-line production and installed assembly cost.
- **Low Maintenance Cost** 44 series connectors can easily be field serviced using inexpensive hand crimp and contact insertion/removal tools, minimizing equipment downtime and maintenance time.
- **Easy Mating** Simple, positive push-pull mating and disconnect require no special assembly instructions. Obvious visual and mechanical mating indicators help avoid damage to components that could result in lost or intermittent circuits.
- **Panel Mounting** 44 series receptacles can be panel mounted, in addition to being used in cable to cable applications.
- **Material** The resilient material used in the Amphenol 44 series connectors proved to be the most resistant to salt spray, shock and vibration. Amphenol Poke-Home® contacts are made of a copper alloy with electrotin plating. The combination of materials provides a highly waterproof connector at a low cost.
- **Available Configurations** 1, 2, 3, 4, 5 and 6 contact configurations are available.
- **Colour** Black

Specifications

Physical Characteristics

Insulation Material : Santoprene, thermoplastic rubber

Contact Material : Copper alloy

Contact Plating : Electrotin

Wire Accommodation: 14, 16 & 18 AWG

Overall Wire Insulation Diameter : 0.080 to 0.130 inches (2.03 to 3.30mm)

Electrical Characteristics

Current Rating : 8 Amps continuous

Voltage Rating : Limiting operation voltage at sea level, 250 Vac RMS

Contact Resistance : < 30 mΩ

Insulation Resistance : > 5,000 MΩ

Dielectric Withstanding Voltage : 1000 VRMS

Mechanical Characteristics

Mating and Unmating Force :

No. of Contacts	Force (lbs)
2	20
3	25
4	30
5	30
6	35

Durability : 25 cycles max.

Vibration : No interruptions < 10 μsec

Contact Retention : axial displacement of contact < 0.03 inch.

Environmental Characteristics

Operating Temperature : -40°C to +105°C

Applications

- Truck accessory disconnects under the hood or frame, on axles, near the engine and in the cab.
- Marine industrial connectors for starter motors, ignition systems, instrumentation and lighting, batteries, controls and fuel injection systems.
- Traffic control equipment connectors for toll booths, railroad gates, traffic signals and highway safety and lighting equipment.
- Automotive safety and security systems, including antiskid braking systems, brake warning indicators, oil pressure indicators, speedometers and burglar alarms.
- RV interconnections between car safety, control systems and trailers or campers.
- Mining ventilation systems and ore car interconnections.

Ordering Information

For Standard Type (Insulation only)

No. of Contacts	Receptacles Part Numbers	Plugs Part Numbers
1	44-104-10001-02	44-103-10001
2	44-104-10002-02	44-103-10002
3	44-104-10003-02	44-103-10003
4	44-104-10004-02	44-103-10004
5	44-104-10005-02	44-103-10005
6	44-104-10006-02	44-103-10006

For Low Insertion Force Type (Insulation only)

No. of Contacts	Receptacles Part Numbers	Plugs Part Numbers
2	44-103-10302	44-103-10302
3	44-103-10303	44-103-10303
4	44-103-10304	44-103-10304
5	44-103-10305	44-103-10305
6	44-103-10306	44-103-10306

Remark : Connector with one contact size is not available in low insertion force type

Contact Part Numbers

Pin Contacts	Socket Contacts	Termination
44-100-1414P-1H(101)	44-102-1414S-1H(101)	(101) deviation specifies contacts removed from reels and individually packaged in bags of 100, 500 or 1000 for hand tool crimping applications
44-100-1414P-5H(101)	44-102-1414S-5H(101)	
44-100-1414P-1K(101)	44-102-1414S-1K(101)	
44-100-1414P-5K	44-102-1414S-5K	Reel of 5000 contacts shipped on carrier strips for use with semi-automatic crimping machine

Automatic Application Tooling

Semi-Automatic Equipment	Part Numbers
Stripper/Crimper	359-2800-1
Contact Crimp Applicator	359-2600-1
Contact Insertion Machine	PN 359-423

Contact Insertion Adapters

Insert Configuration (above)						
	1	2	3	4	5	6
Plug Adapter	359-423-111-01	359-423-111-02	359-423-111-03	359-423-111-04	359-423-111-05	359-423-111-06
Receptacle Adapter	359-423-111-07	359-423-111-08	359-423-111-09	359-423-111-10	359-423-111-11	359-423-111-12

Hand Tools

	Part Numbers
Full Cycle Crimping Tool	357-588
Economy Crimping Tool	357-561

Hand Insertion and Removal Tools

	Contact Part Number	Insertion Tool	Removal Tool
Pin Contact (used with receptable only)	44-100-1414P	356-258	356-259
Socket Contact (used with plugs only)	44-102-1414S	356-258	356-260

Remark : General contact part number for reference only

Dimensions

No. of Contacts	A Dia. Ref (Inches)	B Dia. Ref (Inches)
1	0.497	0.440
2	0.607	0.470
3	0.708	0.570
4	0.819	0.682
5	0.819	0.682
6	0.933	0.796

Insert Configurations

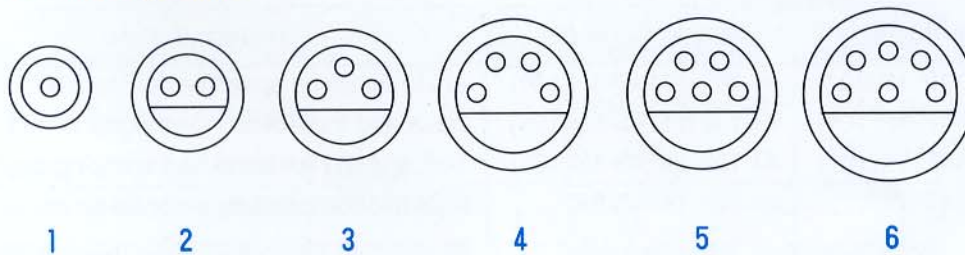

Standard Type

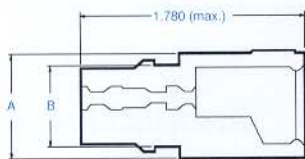

Receptacle

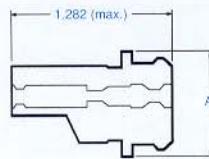

Plug

Low Insertion Force Type

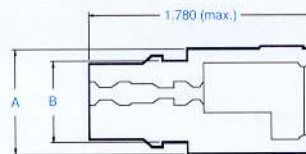

Receptacle

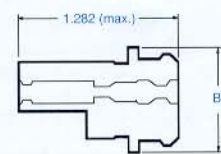

Plug

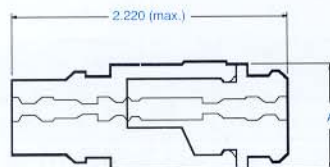

Mated

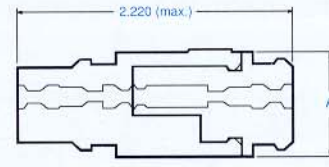

Mated

Amphenol East Asia Limited

Hong Kong Tel: (852) 2699-2663
Fax: (852) 2688-0974

Australia Tel: (61) 8-341-0665
Fax: (61) 8-341-2969

Singapore Tel: (65) 743-3022
Fax: (65) 743-2466

S. Korea Tel: (82) 2-785-1588
Fax: (82) 2-785-1587

Taiwan Tel: (886) 3-379-5677
Fax: (886) 3-360-7259

Amphenol World-wide Sales Offices

Austria Tel: (43) 1985-1511
Fax: (43) 1982-6101

Benelux Tel: (31) 30-635-8019
Fax: (31) 30-634-1783

Canada Tel: (416) 291-4401
Fax: (416) 292-0647

France Tel: (33) 8482-9400
Fax: (33) 8482-9411

Germany Tel: (49) 7131-9290
Fax: (49) 7131-929-400

India Tel: (91) 212-790363
Fax: (91) 212-790581

Italy Tel: (39-2) 939-04192
Fax: (39-2) 939-01030

Japan Tel: (81) 3-3263-5611
Fax: (81) 3-5276-7059

Spain Tel: (34) 1-673-2235
Fax: (34) 1-674-0893

Sweden Tel: (46) 8-590-77100
Fax: (46) 8-590-33800

UK Tel: (44) 1227-773-200
Fax: (44) 1227-771-773

USA Tel: (203) 743-9272
Fax: (203) 796-2091

Notice: Specifications are subject to change without notice. Contact your nearest Amphenol sales office for the latest specifications. All statements, information and data given herein are believed to be accurate and reliable but are presented without guaranty, warranty, or responsibility of any kind, express or implied. Statements or suggestions concerning possible use of our products are made without representation or warranty that any such use is free of patent infringement, and are not recommendations to infringe any patent. The user should not assume that all safety measures are indicated or that other measures may not be required. Amphenol and Spectra-Strip are registered trademarks of Amphenol Corporation.



Amphenol®

©1996 Amphenol Corporation 8/1996 Printed in Hong Kong