

Catamount®

Cable Tie Accessories

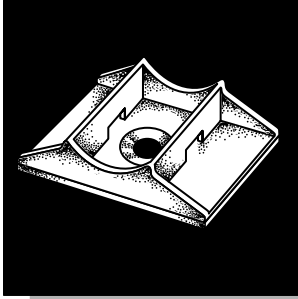

Mounting Cradle

- Accepts cable ties to 50# tensile (miniature through standard).
- Supplied “two-up” on closed cell foam with synthetic polymer “rubber” based adhesive.

- Use #6 self-tapping screw for added strength if desired.
- UL Flammability 94 V-2 (mount).
- Mount molded in 6/6 Natural Nylon.

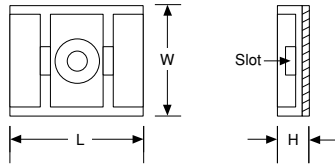

Cat. No.	Material	H Height		L Length		W Width		Slot Height		Slot Width		Mount Method	Bulk Pkg. Qty.
		Inch	(mm)	Inch	(mm)	Inch	(mm)	Inch	(mm)	Inch	(mm)		
MCNY-1250-9-D	Natural Nylon	.285	(7.24)	1.250	(31.73)	1.000	(25.40)	.090	(2.29)	.300	(7.62)	Adhesive	500
MCNY-1250-0-D	Black Nylon	.285	(7.24)	1.250	(31.73)	1.000	(25.40)	.090	(2.29)	.300	(7.62)	Adhesive	500
MCNY-1250-9-C	Natural Nylon	.285	(7.24)	1.250	(31.73)	1.000	(25.40)	.090	(2.29)	.300	(7.62)	Adhesive	100
MCNY-1250-0-C	Black Nylon	.285	(7.24)	1.250	(31.73)	1.000	(25.40)	.090	(2.29)	.300	(7.62)	Adhesive	100
Tolerance ±		.010	(.254)		.015	(.381)		.010	(.254)				

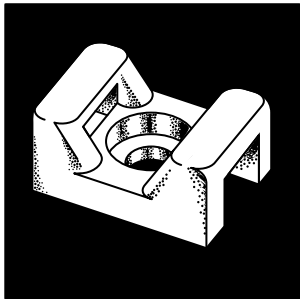

Screw Mount

- SMNY-001 accepts cable ties to 50# Tensile (miniature through standard).
- SMNY-002 accepts cable ties to 120# Tensile (miniature through heavy duty).
- Use #4, #6, #8 or #10 machine screw (as referenced) to apply.

- Stocked in 6/6 Natural or heat stabilized Black Nylon.
- UL Flammability 94 V-2.
- Non-Conductive, Non-Corrosive; resistant to fuels, lubricants and most chemicals.

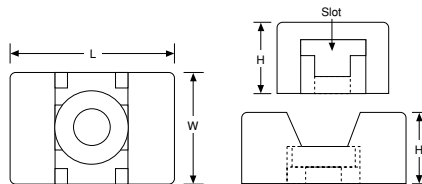

Cat. No.	Material	H Height		L Length		W Width		Slot Height		Slot Width		Mount Method	Bulk Pkg. Qty.
		Inch	(mm)	Inch	(mm)	Inch	(mm)	Inch	(mm)	Inch	(mm)		
SMNY-000-9-D	Natural Nylon	.270	(6.86)	.570	(14.48)	.340	(8.64)	.070	(1.78)	.120	(3.10)	#4 Screw	
SMNY-001-9-D		.280	(7.11)	.600	(15.24)	.385	(9.77)	.060	(1.52)	.200	(5.08)	#6, #8 Screw	
SMNY-002-9-D		.390	(9.90)	.875	(22.22)	.625	(15.87)	.090	(2.29)	.325	(8.26)	#8, #10 Screw	500
SMNY-001-0-D	Heat Stabilized Black Nylon	.280	(7.11)	.600	(15.24)	.385	(9.77)	.060	(1.52)	.200	(5.08)	#6, #8 Screw	
SMNY-002-0-D		.390	(9.90)	.875	(22.22)	.625	(15.87)	.090	(2.29)	.325	(8.26)	#8, #10 Screw	
SMNY-002-9C		.390	(9.90)	.875	(22.22)	.625	(15.87)	.090	(2.29)	.325	(8.26)	#8, #10 Screw	100
SMNY-002-0-C		.390	(9.90)	.875	(22.22)	.625	(15.87)	.090	(2.29)	.325	(8.26)	#8, #10 Screw	100
Tolerance ±						.015	(.381)						