

Connectors

COPPER MECHANICAL CONNECTORS

SINGLE LUG - CU - EXTRUDED STYLE

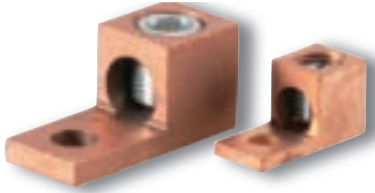

Solid one-piece copper connector made from extruded copper for superior mechanical strength and excellent electrical performance. Steel screw. Suitable for use with copper wire only. Rated 600 volts.

CATALOG NO.	UPC CODE	WIRE RANGE	LENGTH	HEIGHT	WIDTH	MTG. HOLE	CARTON QTY.	CAT. NO.
6TC	00500	6-14	1.020	.400	.375	.193	100	3
4TC	00501	4-14	1.075	.440	.450	.265	100	4
2TC	00502	2-14	1.125	.484	.458	.265	100	5
0TC	00503	1/0-14	1.277	.660	.548	.265	50	8
4/0TC	00504	4/0-2	1.950	.950	.812	.390	25	13

SINGLE LUG - CU - TUBULAR STYLE

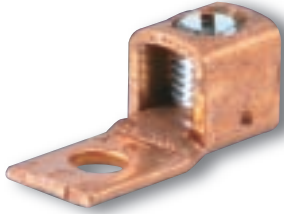

Copper connector made from tubular copper. Steel screw. Suitable for use with copper wire only. Rated 600 volts.

CATALOG NO.	UPC CODE	WIRE RANGE	LENGTH	HEIGHT	WIDTH	MTG. HOLE	CARTON QTY.	CAT. NO.
6TC-1	00505	6-14	.995	.778	.345	.203	100	2.1
4TC-1	00506	4-14	1.255	.831	.453	.258	100	3.5

SINGLE AND DOUBLE SOLDERLESS LUGS

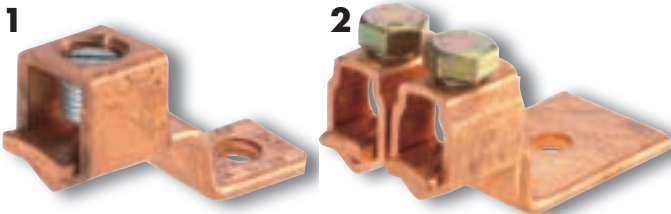

Made of 99.98% pure electrolytic copper. Steel-plated screws to prevent rusting. 25 to 70 ampere size have slotted head screws. Larger sizes have hex head screws. Rated 600 volts.

CATALOG NO.	UPC CODE	FIG. NO.	WIRE RANGE	MTG. HOLE	AMPERE RATING	CARTON QTY.	SHPG.WT. LBS./100
DE703	00510	1	10-14	1/8	25	100	1.3
DE704	00511	1	6-14	3/16	35	100	2.3
DE705	00512	1	2-8	1/4	70	100	5.1
DE711	00513	1	4-14	1/4	70	50	3.2
DE706	00514	1	1/0-6	1/4	125	25	10.8
DE713	00515	1	3/0-4	3/8	175	18	17
DE707	00516	1	4/0-2	5/16	225	15	24.7
DE710	00517	1	350-1/0	3/8	300	10	50
DE708	00518	1	500-4/0	3/8	400	2	79.8
DE709	00519	1	1000-600	1/2	650	2	202.0
D899	00520	2	4/0-2	3/8	450	6	60
D900	00521	2	350-1/0	3/8	600	6	100
D901	00522	2	500-1/0	1/2	800	3	155
DE713SP*	00525	*	3/0-4	3/8	175	18	18

*DE 713SP is plated and is supplied with a straight tang.